

# || HAGER MARK V AVIATOR AUTOMATIC WATCH

The Mark V was made for those who appreciate subtlety. In a world governed by the latest trends and hottest watch fashions and fickleness, the Mark V is an instant classic with retro aesthetics and makes a bold statement. The Mark V is a classic because it is a watch that will last forever and never be out of fashion, because it doesn't belong to fashion. The Mark V is understated, not trendy, and you can comfortably wear the Mark V in any decade.

## CHARACTERISTICS OF YOUR AUTOMATIC WATCH

This mechanical watch operates using power obtained from a mainspring.

- If the watch is completely stopped, manually turn the crown approximately 20 times to wind up the mainspring to start the watch.
- While loss/gain of a quartz watch is indicated by a monthly or annual rate, accuracy of a mechanical watch is normally indicated by a daily rate (loss/gain per day).
- Normal usage accuracy of a mechanical watch varies according to conditions of use (time period that the watch is worn on the wrist, temperature environment, hand movement, and winding state of the mainspring).
- When the watch is affected by strong magnetism, it temporarily gains or loses time. If the watch encounters a strong magnetic field, the parts of the watch may be magnetized. In this case, repairs such as removal of magnetism are required. Do not leave the watch in place where it will be subjected to strong magnetism (for example, near television sets, loudspeakers or magnetic necklaces) or static electricity. Contact us if this should happen.
- The Hager MKV Aviator comes with a one year limited warranty. See our website [www.HagerWatches.com](http://www.HagerWatches.com) for more details.

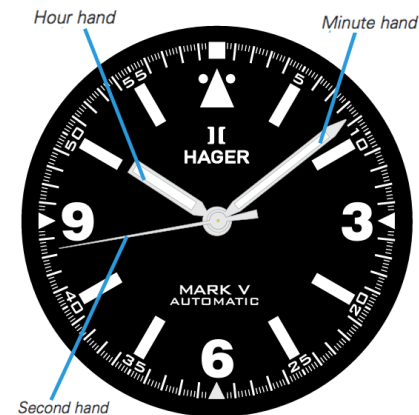

## WATCH

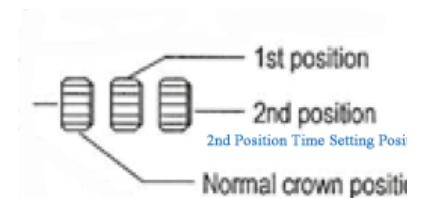

## HOW TO USE YOUR WATCH

This watch is an automatic watch equipped with a manual winding mechanism

- When the watch is worn on the wrist, the motion of the wearer's arm winds the mainspring of the watch.
- If your watch is completely stopped, it is recommended that you manually wind the mainspring by turning the crown clockwise.
- To either wind the watch or set the time begin by unscrewing the watch counter clockwise until the crown “pops” off the threads.

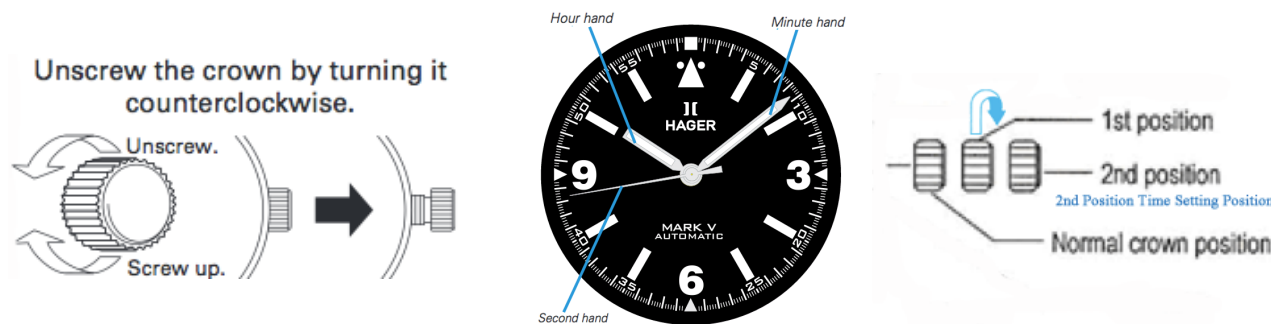

### How to manually wind the mainspring by turning the crown

- After unscrewing your crown, leave the watch in the normal crown position and slowly turn the crown clockwise (in the 12 o'clock direction) to wind the mainspring (*Turning the crown counterclockwise (the 6 o'clock direction) does not wind the mainspring*).
- Continue to turn the crown until the mainspring is sufficiently wound. The second hand will start moving.

### HOW TO SET THE TIME

After unscrewing your crown, pull the crown out to the 1<sup>st</sup> click (Position 1), then gently pull it out to the 2<sup>nd</sup> click (position 2). The second hand will stop. Slowly advance the hands clockwise till you reach the desired time. Once the watch is wound up fully, it operates for about 36 hours.

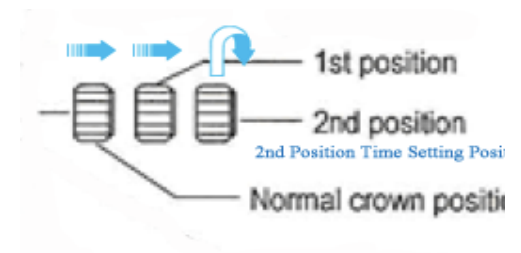

- If the watch is used without being wound up fully, gain or loss of the watch may result. To avoid this, wear the watch for more than 10 hours a day. If the watch is used without wearing on the wrist (if it sits on a desk etc.), be sure to wind it up fully every day at a fixed time.
- When you have completed setting the time gently push the crown back in and screw it back clockwise.

## CARE OF YOUR NEW WATCH



Your watch is designed and manufactured to withstand up to 5 bar. such as accidental contact with splashes of water or rain, but it is not designed for wearing while swimming or diving

Before using a watch in water, make sure the crown is pushed in completely. Do not operate the crown when the watch is wet or in water. If used in seawater, rinse the watch in fresh water and dry it completely.

When taking a shower while wearing a water resistant 5 bar watch, or taking a bath while wearing a water resistant 10, 15 or 20 bar watch, make sure to observe the following:

- Do not operate the crown when the watch is wet with soapy water or shampoo.
- If the watch is left in warm water, a slight time loss or gain may be caused.

This condition, however, will be corrected when the watch returns to normal temperature.

## TROUBLESHOOTING

Problem	Possible causes	Solutions
The watch stops operating.	The power supplied by the mainspring has been consumed.	Turn the crown or swing the watch to wind it up. The watch will start operating.
Even though you wear the watch every day, it soon stops operating.	The watch is worn on your wrist only for a short period of time, or the amount of arm movement is small.	Wear the watch for an extended period of time, or when taking off the watch, turn the crown to wind the mainspring.

## ACCURACY OF MECHANICAL WATCHES

- The accuracy of mechanical watches is indicated by the daily rates of one week or so.
- The accuracy of mechanical watches may not fall within the specified range of time accuracy because of loss/gain changes due to the conditions of use, such as the length of time during which the watch is worn on the wrist, arm movement, whether the mainspring is wound up fully or not, etc.
- The key components in mechanical watches are made of metals which expand or contract depending on temperatures due to metal properties. This exerts an effect on the accuracy of the watches. Mechanical watches tend to lose time at high temperatures while they tend to gain time at low temperatures.
- In order to improve accuracy, it is important to regularly supply energy to the balance that controls the speed of the gears. The driving force of the mainspring that powers mechanical watches varies between when it is fully wound and immediately before it is unwound. As the mainspring unwinds, the force weakens.

Relatively steady accuracy can be obtained by wearing the watch on the wrist frequently for the self-winding type and winding up the mainspring fully everyday at a fixed time to move it regularly for the wind-up mechanical type.

## SPECIFICATIONS

### Movement

**Caliber:** HGR48 Automatic

**Functions:** hours, minutes and seconds

**Size:** 11 1/2"

**Jewels:** 25 Jewels

**Power Reserve:** 36 Hours

**Hz:** 4/28'800 vibrations per hour

**Finish:** Gold plated with company logo laser engraved on the rotor.

### Case, Dial & Hands

**Material/Finish:** Titanium/Bead Blasted

**Diameter:** 39mm

**Height:** 13mm

**Water Resistance:** 5 ATM/50m

**Case Back:** Bead Blasted with WWII AF Wings

**Crystal:** Domed Sapphire crystal

**Dial:** Black with SuperLuminova coated indexes

**Crown:** Screw-down