

DIPLOMAT



HAGER



An American Brand

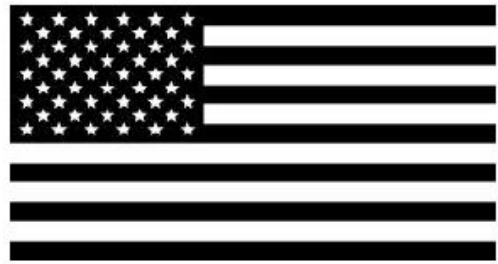

**Hagerstown, MD**

# DIPLOMAT

*Horological harmony. . . Simplicity is the ultimate sophistication*

Congratulations on the purchase of your Hager Diplomat. There are some watches that not only stand the test of time, but also transcend their original intent to become classics. This collection of the Diplomat is versatile, represents our American heritage, and is guaranteed to offer a model that suits your signature style. Vintage vibes, classic American style in a wear-anywhere watch to be worn in every situation.

These are conservatively styled watches that recall a by-gone decade with elements like convex gradient fumé dials, Arabic numeral font, knurled tapered crown that creates a slight space between the crown and the case proper, hand-finished bevelled edges of the case and sleek streamlined minimalist diamond cut dauphine hands. The clean uncluttered dial retains a sense of visual balance, making it pleasing to the eye and easy to read.

In the following pages you will learn about your new watch. Enjoy your new watch!



# DIPLOMAT SECONDS AT SIX POSITION INSTRUCTIONS



*After an extended period of non-use, the movement must be set in motion by winding the crown clockwise in its normal position approximately 20 times.*

**Flush-** The crown is in the first position. The watch is in the manual winding position.

**(1st Position)** For Manual Winding- If the watch has not been worn in some time and needs to be started for use, rotate the crown in a continuous clockwise movement in this position (without putting any side-pressure on the crown to push it inward into its screw-down position). It is recommended that the watch be started in this fashion before setting it. 5-6 turns of the crown should be sufficient to get the watch running.

**(2nd Position)** Date- This position is an “empty position”. Because of the nature of the movement this is an empty or ghost position. If you find that you are trying to wind your watch and the crown is just spinning freely without winding you are more than likely in position two. Pull the crown out to position 3 and then push firmly back into position one. This should solve the problem.

**(3rd Position)** Setting the Time- Extend the crown past the 2nd position, which is fully extended from the side (this also activates the “hacking” feature). To set the time, wind the crown clockwise or counterclockwise until you reach the appropriate time. If you feel like there is either resistance or the hands are not flowing freely, push the crown back into position 1 and then firmly but not forcefully pull the crown and stem out to position 3. When completed, lightly push the crown back into position 1 and gently screw the crown in clockwise direction, then tighten it again until you feel some resistance. **Do not force!**

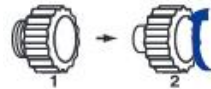

**PLEASE BE ADVISED:** Forcefully pulling out the crown is NOT/NOT covered by the warranty. Please use your thumb and forefinger to gently pull out the crown and stem.

# DIPLOMAT CENTRE SECONDS INSTRUCTIONS

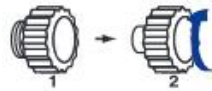

*After an extended period of non-use, the movement must be set in motion by winding the crown clockwise in its normal position approximately 20 times.*

**Flush-** The crown is in the first position. The watch is in the manual winding position.

**(1st Position)** For Manual Winding- If the watch has not been worn in some time and needs to be started for use, rotate the crown in a continuous clockwise movement in this position (without putting any side-pressure on the crown to push it inward into its screw-down position). It is recommended that the watch be started in this fashion before setting it. 5-6 turns of the crown should be sufficient to get the watch running.

**(2nd Position)** Setting the Time- Extend the crown past the 1st position, which is fully extended from the side (this also activates the “hacking” feature). To set the time, wind the crown clockwise or counterclockwise until you reach the appropriate time. If you feel like there is either resistance or the hands are not flowing freely, push the crown back into position 1 and then firmly but not forcefully pull the crown and stem out to position 3. When completed, lightly push the crown back into position 1 and gently screw the crown in clockwise direction, then tighten it again until you feel some resistance. **Do not force!**

**PLEASE BE ADVISED:** Forcefully pulling out the crown is NOT/NOT covered by the warranty. Please use your thumb and forefinger to gently pull out the crown and stem.

## TROUBLESHOOTING

Problem	Possible causes	Solutions
The watch stops operating.	The power supplied by the mainspring has been consumed.	Turn the crown or swing the watch to wind it up. The watch will start operating.
Even though you wear the watch every day, it soon stops operating.	The watch is worn on your wrist only for a short period of time, or the amount of arm movement is small.	Wear the watch for an extended period of time, or when taking off the watch, turn the crown to wind the mainspring.

## ACCURACY OF MECHANICAL WATCHES

- The accuracy of mechanical watches is indicated by the daily rates of one week or so.
- The accuracy of mechanical watches may not fall within the specified range of time accuracy because of loss/gain changes due to the conditions of use, such as the length of time during which the watch is worn on the wrist, arm movement, whether the mainspring is wound up fully or not, etc.
- The key components in mechanical watches are made of metals which expand or contract depending on temperatures due to metal properties. This exerts an effect on the accuracy of the watches. Mechanical watches tend to lose time at high temperatures while they tend to gain time at low temperatures.
- In order to improve accuracy, it is important to regularly supply energy to the balance that controls the speed of the gears. The driving force of the mainspring that powers mechanical watches varies between when it is fully wound and immediately before it is unwound. As the mainspring unwinds, the force weakens.

Relatively steady accuracy can be obtained by wearing the watch on the wrist frequently for the self-winding type and winding up the mainspring fully everyday at a fixed time to move it regularly for the wind-up mechanical type.



## *MOVEMENT*

### **HGR 1165 / 7081**

Self-winding mechanical movement

**Functions:** Hour & Minute Hands at the Center, Sub-Second Hand at 6 o'clock or Centre Seconds, Self Winding.

**Total Diameter:** 26.0mm

**Thickness:** 5.85mm

**Height:** 6.9mm

**Jewels:** 35 Jewels

**Power Reserve:** 40 Hours

**Beat Rate:** 4Hz/28'800 vibrations per hour/ Automatic in two directions

**Accuracy:** -4/+20 seconds per day

# WARRANTY INFORMATION

Your Hager wristwatch has been designed to give you years of outstanding timekeeping performance. You may, however, have some questions about your watch's guarantee or its regular servicing intervals. This section of the User Manual has been created to answer your questions and to provide you with information that will help you make sure your timepiece works optimally for as long as you wear it. Your Hager® watch is warranted by HAGER\* for a period of twenty-four (24) months.

**A mechanical watch is a precision mechanism which is asked to work 24 hours a day, indefinitely. Treat it with respect. Each Hager timepiece is designed and manufactured to the highest of standards.**

**This manufacturer's warranty does not cover:**

- normal wear and tear and ageing (for example scratched crystal; bezel; metallic bracelet). Damage to the crown.
  - any damage on any part of the watch resulting from abnormal/ abusive use, lack of care, negligence, accidents (knocks, dents, crushing, broken crystal, etc.), incorrect use of the watch and non- observance of the operating instructions provided by HAGER.
  - the Hager watch handled by non-authorized persons (for service or repair) or which has been altered in its original condition beyond HAGER's control.
- Any consequential or indirect damage resulting from the use, failure to operate, defects or lack of precision of the Hager watch. HAGER's OBLIGATION IS STRICTLY LIMITED TO REPAIR OR REPLACEMENT AS EXPRESSLY STATED IN THIS LIMITED WARRANTY. **Please be aware that:**
- Goods presented for repair may be replaced by refurbished goods of the same type rather than being repaired. Refurbished parts may be used to repair the goods.

## HOW TO MAKE A CLAIM UNDER THIS WARRANTY

In the unlikely event that service is required during the guarantee period, we recommend that you first contact [info@hagerwatches.com](mailto:info@hagerwatches.com). You will be responsible for paying the expenses associated with making a claim under this Warranty, including postal or delivery expenses and any relevant taxes. Repairs after the guarantee period will be charged. Owner will be charged for postage, insurance and such costs as may be incurred outside the normal repair costs under the guarantee. Our service is, of course, also available after the guarantee period has expired for repair and maintenance work against an appropriate charge. [Payment in advance]. Sometimes it is cheaper to contact first a qualified watchmaker in your area. Please ask your watchmaker for a free estimate!

**Special recommendations:** What must I do to ensure that my Hager watch provides me with excellent service for many years?

**Magnetic fields:** avoid placing your watch on computers, loudspeakers or refrigerators, since they generate powerful magnetic fields.

**Swimming in the sea:** always rinse your watch with fresh water afterwards.

**Shocks:** whether physical, thermal or other, avoid them.

**Screw-down crown:** screw the crown down carefully to prevent water from penetrating the case.

**Cleaning:** for metal bracelets, and water-resistant cases, use a toothbrush and soapy water for cleaning and dry with a soft cloth.

**Chemical products:** avoid direct contact with solvents, detergents, perfumes, cosmetics etc., since they may damage the bracelet, case or gaskets.

**Temperature:** avoid exposure to extreme temperatures (greater than 60°C, or 140°F, less than 0°C, or 32°F) or extreme temperature changes.

**Water-resistance:** a watch's water-resistance cannot be permanently guaranteed. It may notably be affected by the ageing of gaskets or by an accidental shock to the crown. We recommend you have the water resistance of your watch checked once a year by an authorized Service Center.





© **Hager** Watches

36 South Potomac Street  
Suite 204  
Hagerstown, MD 21740

**HAGERWATCHES.COM**

**[hager.watches@gmail.com](mailto:hager.watches@gmail.com)**

**<https://twitter.com/hagerwatches>**

**<https://www.facebook.com/HagerWatches>**

*HAGER reserves the right to modify the models illustrated in this catalogue at any time.*